

***F* CADEX**



HUB MAINTENANCE MANUAL

Index

1. Hub Lineup in Gear	3
2. Hub Bearing Tool Box	4
3. Front Rim Brake Hub	
3-1 Hub Disassembly	5
3-2 Hub Assembly	6
4 Front Disc Brake Hub	7
4-1 Hub Disassembly	8
4-2 Hub Assembly	9
5. Rear Rim / Disc Brake Hub	10
5-1 Hub Disassembly	11
5-2 Hub Assembly	12
	13
	14
	15
	16
	17
	18
	19
	20
	21

1 Hub Lineup in Gear

Part No.	Model name	Description
300000068	CADEX RB FRONT HUB	CADEX RB F HUB 16X100 5MM
300000069	CADEX DB FRONT HUB	CADEX DB F HUB 21X100 12MM CENTERLOCK
300000070	CADEX RB REAR HUB 11S	CADEX RB R HUB 11S 21X130 5MM
300000071	CADEX RB REAR HUB 12S	CADEX RB R HUB 12S 21X130 5MM XDR
300000072	CADEX DB REAR HUB 11S	CADEX DB R HUB 11S 24X142 12MM
300000073	CADEX DB REAR HUB 12S	CADEX DB R HUB 12S 24X142 12MM XDR
300000062	TOOL SET	CADEX HUB BEARING TOOL SET
300000052	FREE HUB BODY	CADEX FREE HUB BODY KITS SHIMANO 11S
300000053	FREE HUB BODY	CADEX FREE HUB BODY KITS SRAM XDR 12S
300000054	HUB BEARINGS	CADEX FRONT HUB BEARINGS RIM BRAKE
300000055	HUB BEARINGS	CADEX REAR HUB BEARINGS RIM BRAKE
300000063	HUB BEARINGS	CADEX FRONT HUB BEARINGS DISC BRAKE
300000064	HUB BEARINGS	CADEX REAR HUB BEARINGS DISC BRAKE
300000056	CADEX GREASE	CADEX GREASE FOR RACHETS 50G
300000057	CADEX RATCHET	CADEX RATCHET KIT(2 RATCHETS, 1 SPRING)
300000058	CADEX HUB END CAP	CADEX HUB END CAP 100*5
300000059	CADEX HUB END CAP	CADEX HUB END CAP 130*5 SHIMANO 11S
300000065	CADEX HUB END CAP	CADEX HUB END CAP 130*5 SRAM 12S
300000060	CADEX HUB END CAP	CADEX HUB END CAP 100*12
300000061	CADEX HUB END CAP	CADEX HUB END CAP 142*12 SHIMANO 11S
300000066	CADEX HUB END CAP	CADEX HUB END CAP 142*12 SRAM 12S

2 Hub Bearing Tool Box



After every bearing replacement, please glue the bearing into the hub shell by using Loctite 290 and dry for 24+ hours. Pay special attention not to let excess Loctite dry on the waterproof cover. Clean off excess glue immediately.

⚠ Glue both sides of front hub, non-drive side of rear hub.

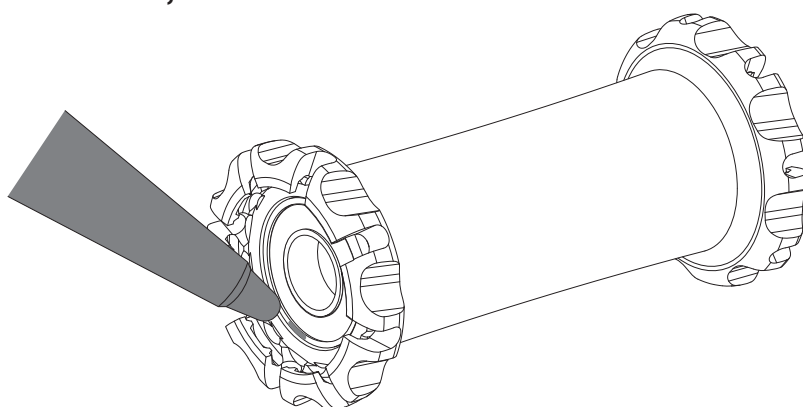

3 Front Rim Brake Hub

3-1 Hub Disassembly

STEP 1

Take off the end caps.

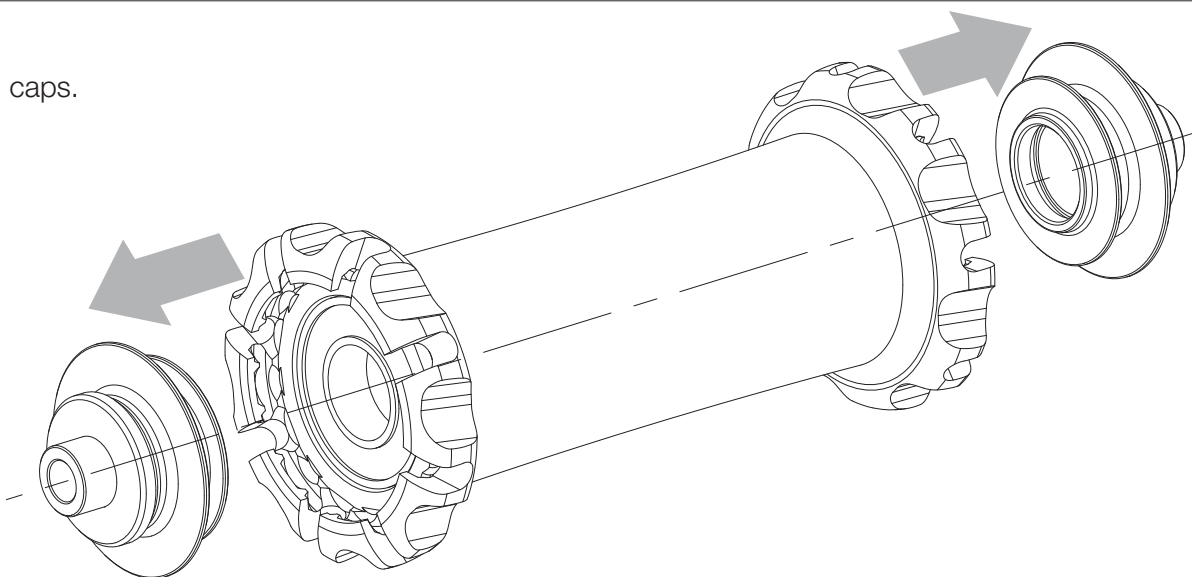

STEP 2

- Attach the threaded axle to one of the spindles.
- Mount **Tool 02** onto the threaded axle.
- Insert the threaded axle into the bearing axle.
- Mount **Tool 07** on the threaded axle with the wide side towards the hub.
- Attach the second spindle to the threaded axle.

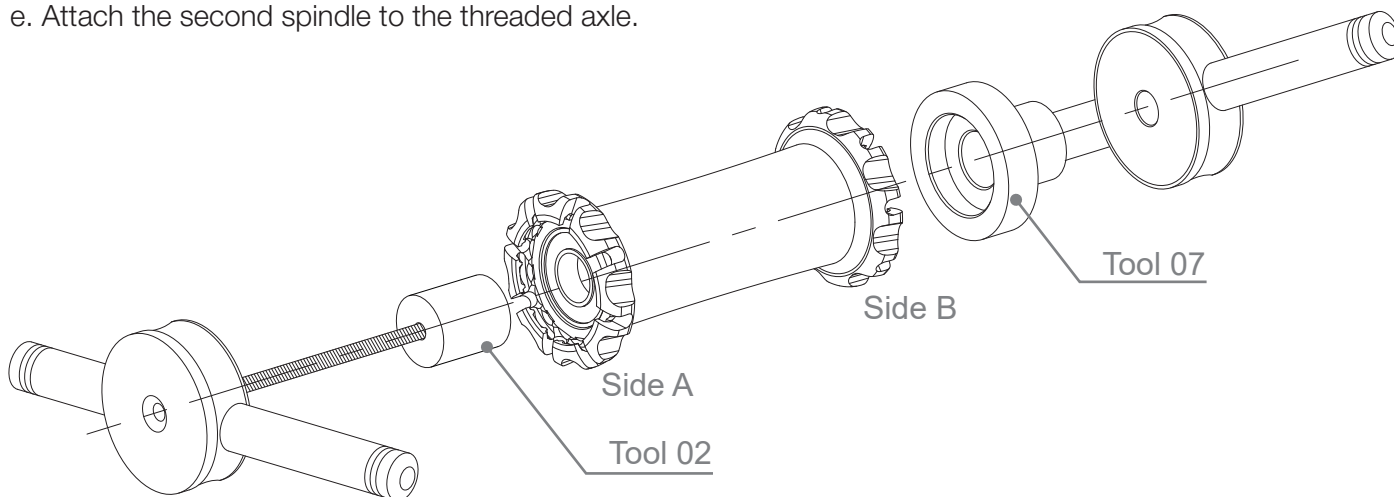

STEP 3

- a. Tighten the spindles, the bearing at **Tool 07** side will be pushed out of the hub shell.
- b. Loosen the spindles to take out the threaded axle take off the disassembled bearing.

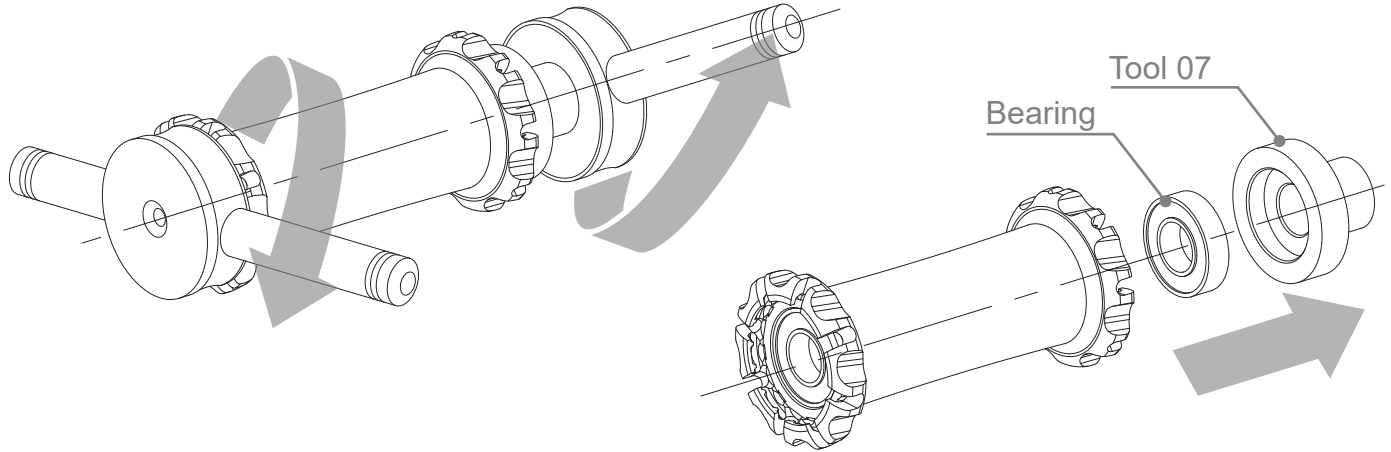

STEP 4

- a. Re-insert the threaded axle in the hub axle.
 - * **Tool 07** at the side with bearing.
 - * **Tool 02** at the side without bearing.
- b. Tighten the spindles, the bearing at **Tool 07** side will be pushed out of the hub shell.

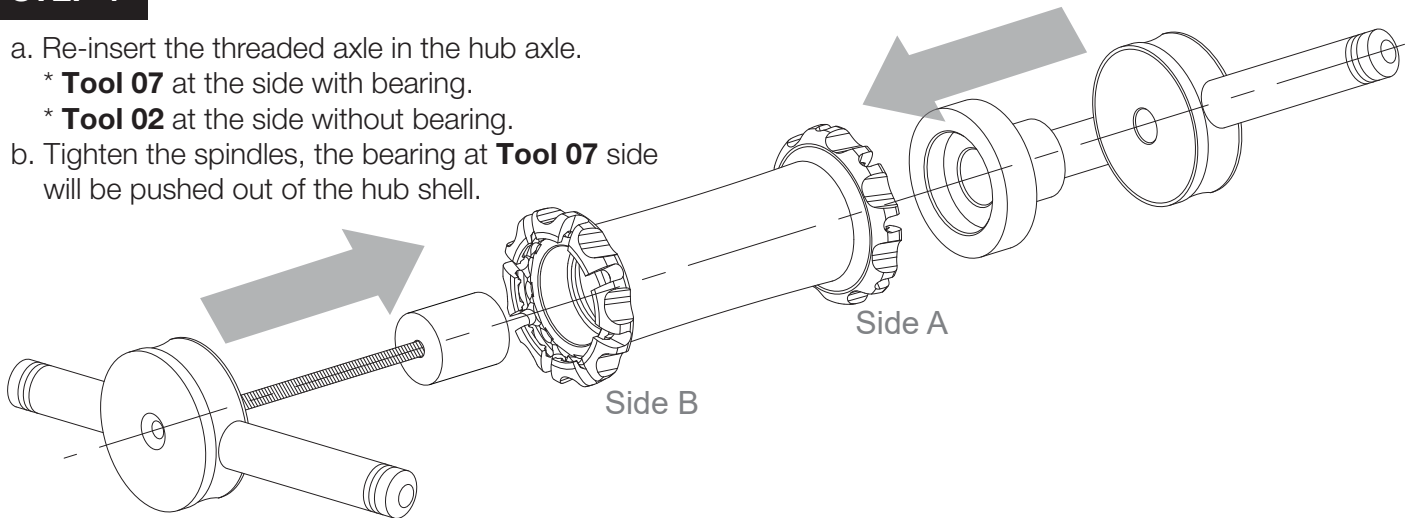

3-2 / Hub Assembly

STEP 1

- Insert Tool 08 in the hub shell
- Slide the new bearing onto the narrow end of **Tool 08**. Orange side of bearing facing outwards.

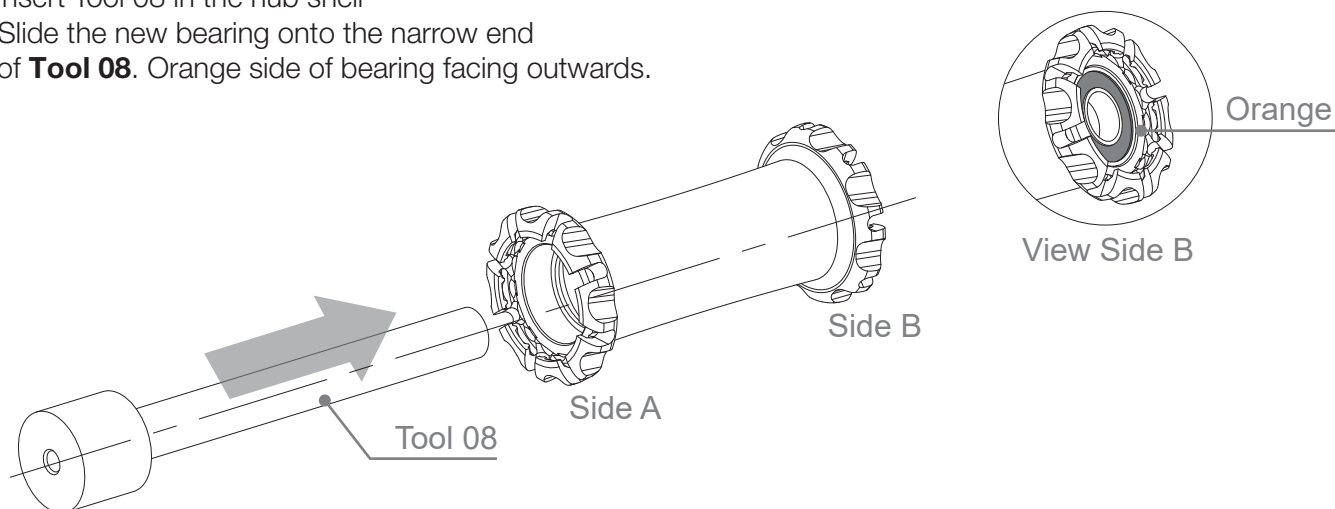

STEP 2

- Mount threaded axle on a spindle and insert it in **Tool 08**.
- Mount **Tool 6901** on the threaded axle (against the bearing) and mount the other spindle.
- Tighten the spindles until the bearing is fully pressed into the hub shell.

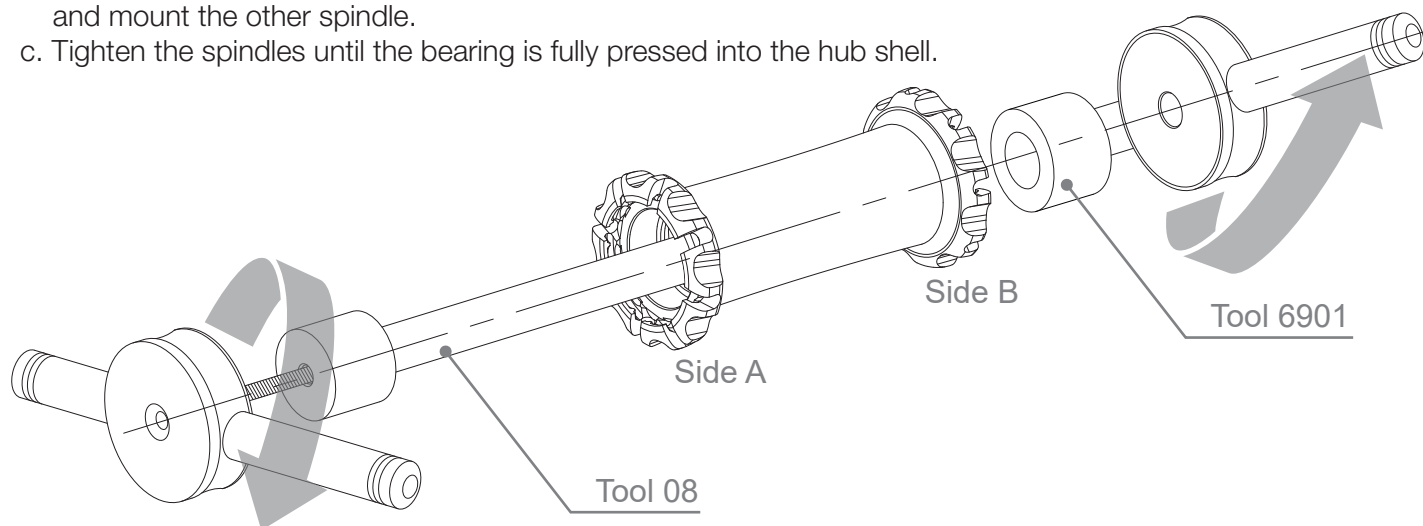

STEP 3

- Insert the hub axle through the hub shell, into the mounted bearing.
- Mount **Tool 6901** on the threaded axle against the spindle
- Mount a bearing on the hub axle at the side where no bearing is mounted yet.
- Insert the threaded axle through the axle from the mounted bearing side.
- Slide the second **Tool 6901** on the threaded axle and mount the other spindle
- Tighten the spindles until the bearing is fully pressed into the hub shell.

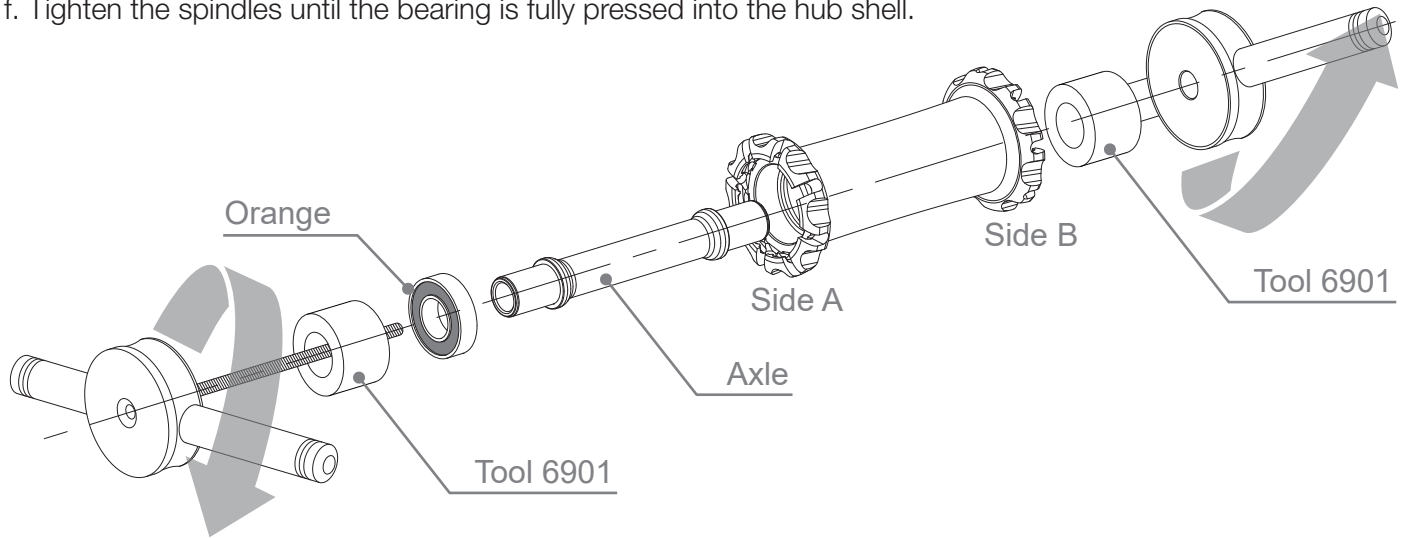

STEP 4

Mount the end caps on the hub.

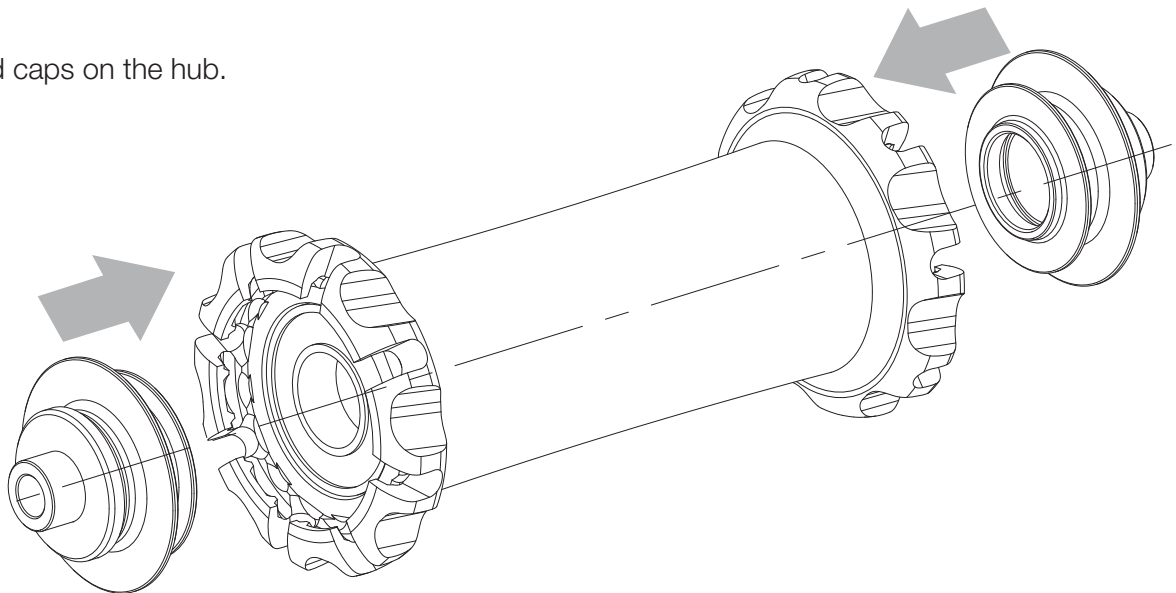

4 Front Disc Brake Hub

4-1 Hub Disassembly

STEP 1

Take off the end caps.

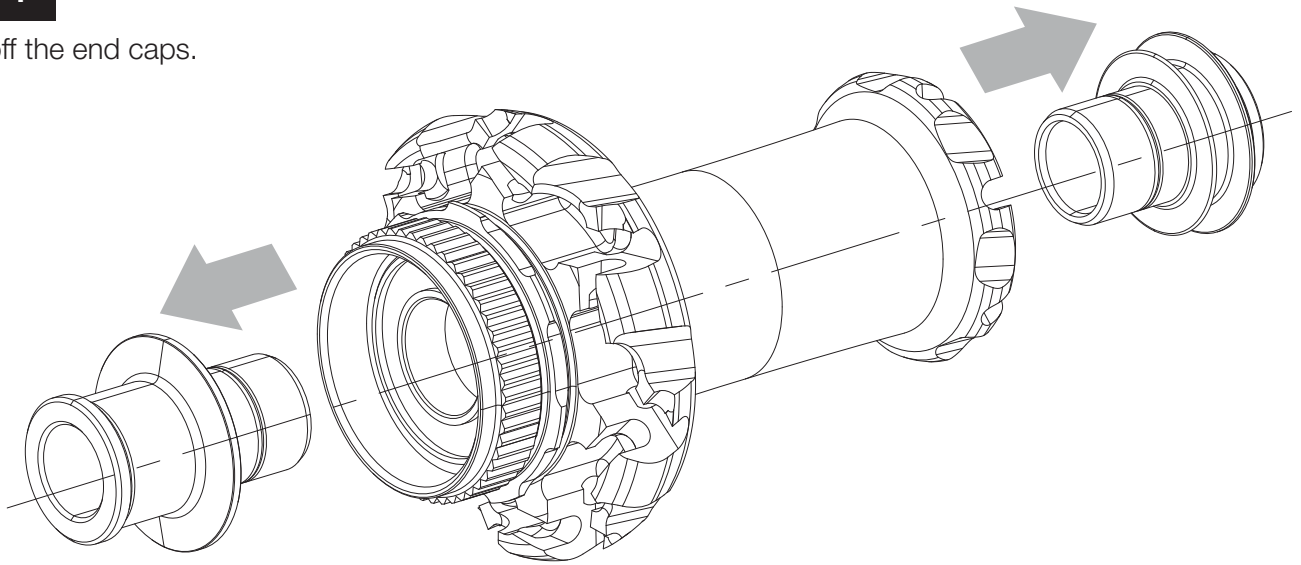

STEP 2

Inside the hub there is a steel bushing.

- Slide the bushing off center.
- Tool 09** should rest against the steel bushing.

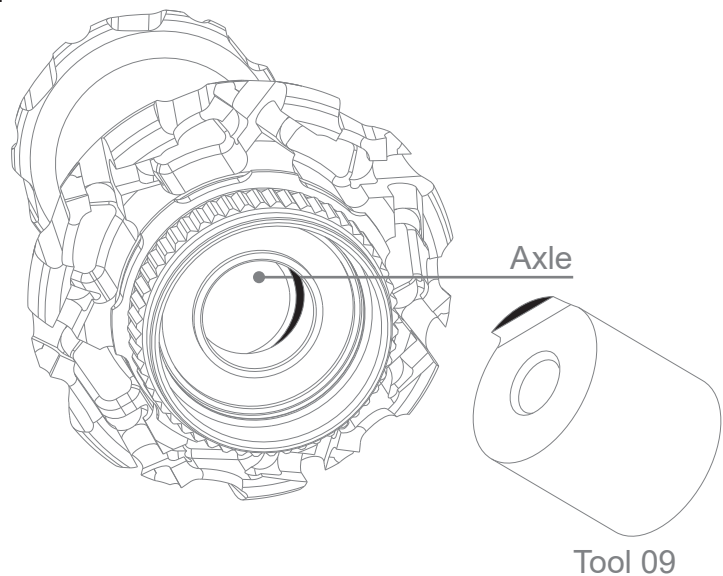

STEP 3

Remove bearing of Non-disc side.

- Attach the threaded axle to one of the spindles.
 - Mount **Tool 02** & **Tool 09** onto the threaded axle.
 - Insert the threaded axle into the bearings from the disc side.
 - Mount **Tool 07** on the threaded axle at the non disc side with the wide side towards the hub.
- Attach the second spindle to the threaded axle.

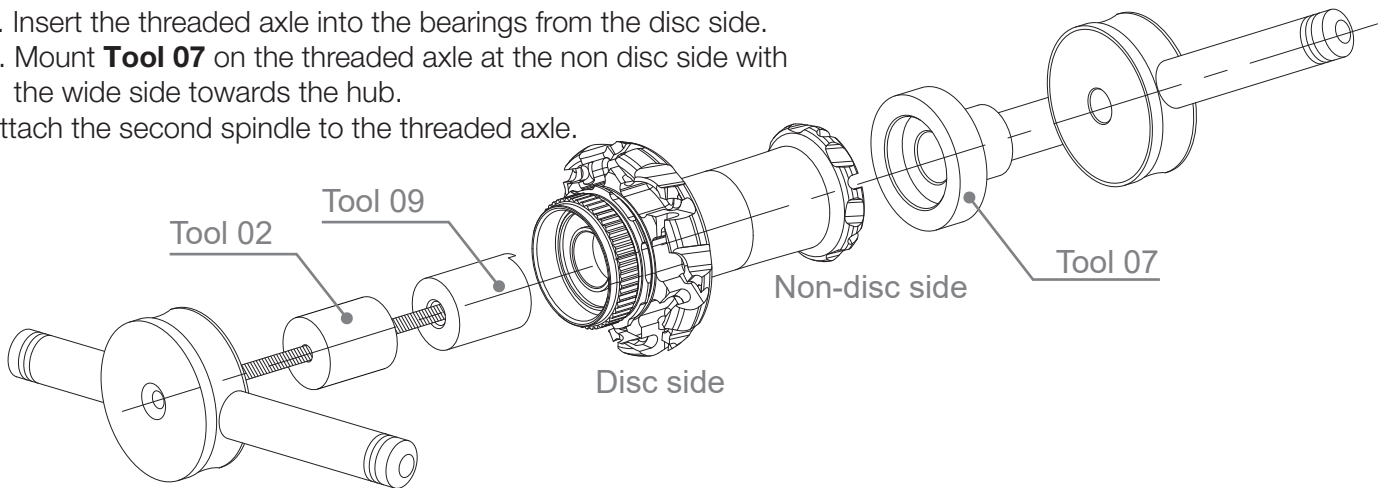

STEP 4

- Tighten the spindles, the bearing at **Tool 07** side (non disc) will be pushed out of the hub shell.
- Loosen the spindles to take out the threaded axle take off the disassembled bearing.

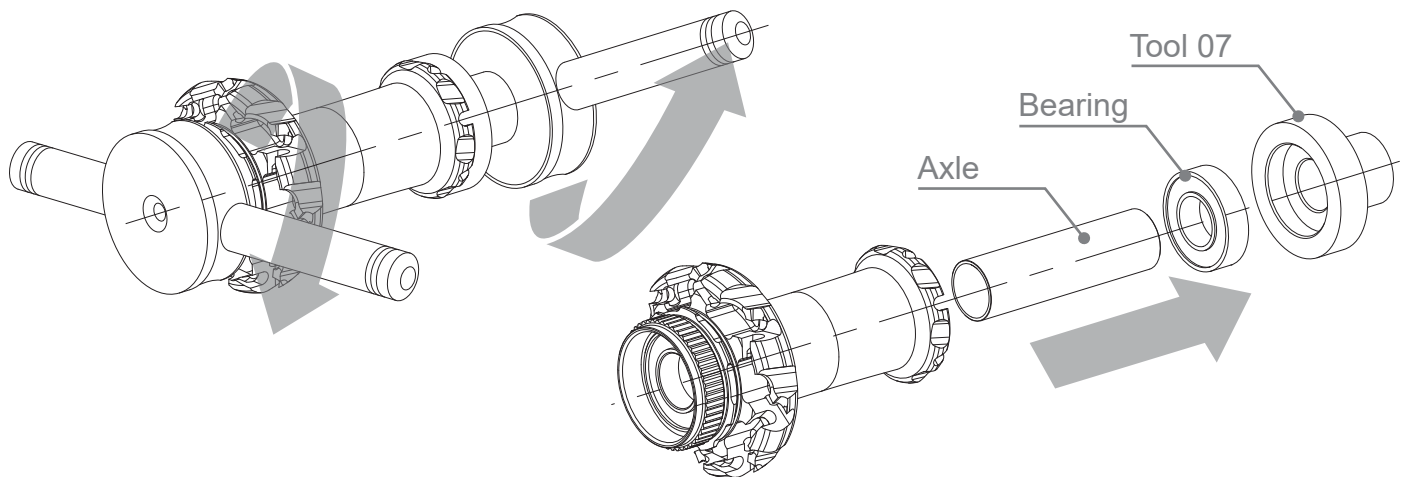

STEP 5

Remove bearing of Disc side.

- Attach the threaded axle to one of the spindles.
- Mount **Tool 07** on the threaded axle and insert the threaded axle into the hub from the disc side.
- Mount **Tool 02 & Axle** onto the threaded axle.
- Attach the second spindle to the threaded axle.

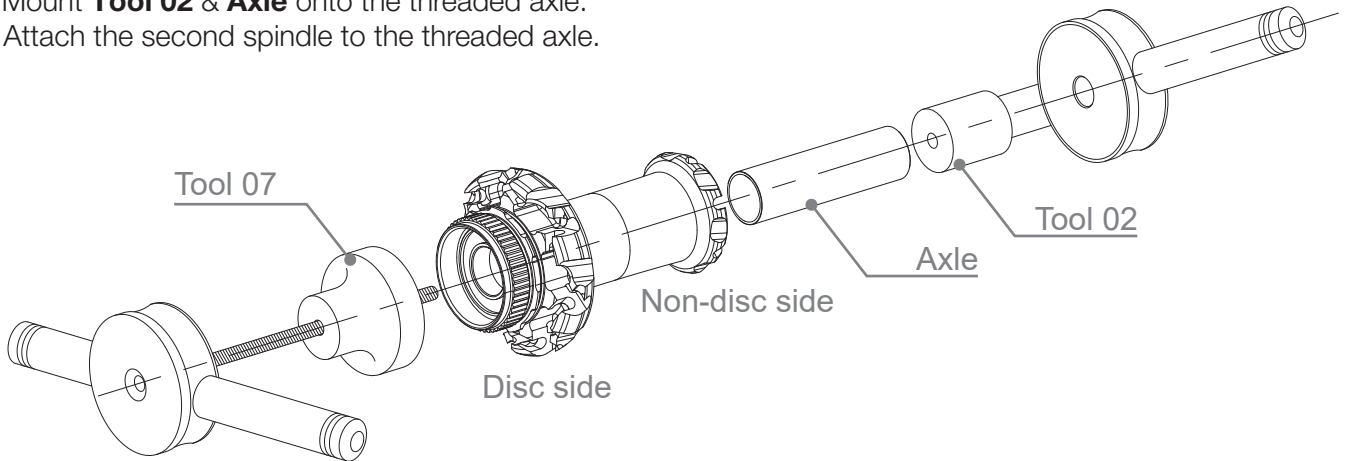

STEP 6

- Tighten the spindles, the bearing at **Tool 07** side (disc) will be pushed out of the hub shell.
- Loosen the spindles to take out the threaded axle take off the disassembled bearing.

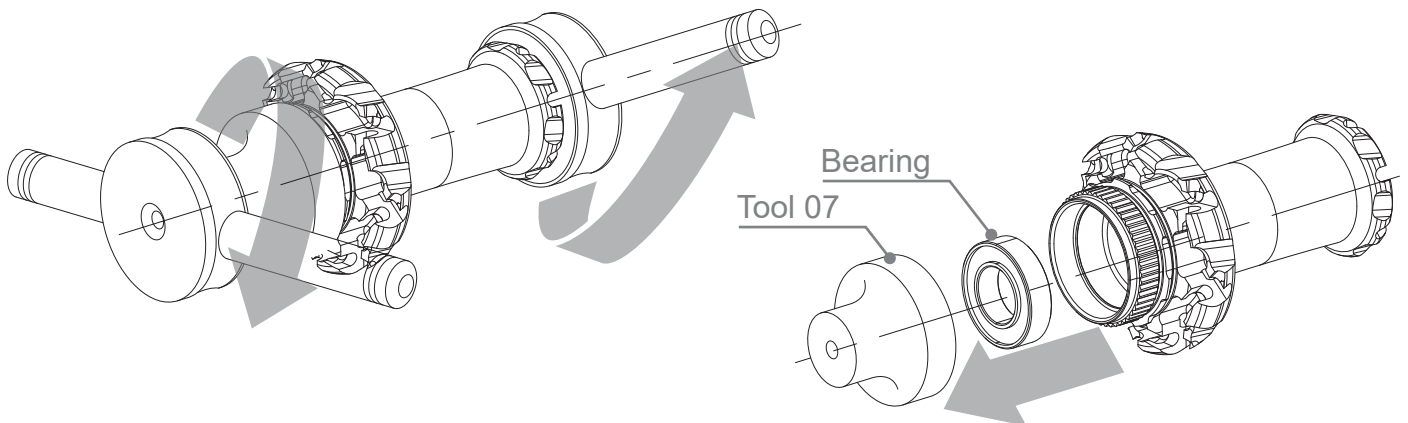

4-2 / Hub Assembly

STEP 1

Assemble bearing of Disc side.

- Attach the threaded axle to one of the spindles.
- Mount Tool 01 on the threaded axle (wide side towards the spindle), place a new bearing on **Tool 01** and insert the threaded axle into the hub from the disc side.
- Slide **Tool 08** on the threaded axle and attach the second spindle.

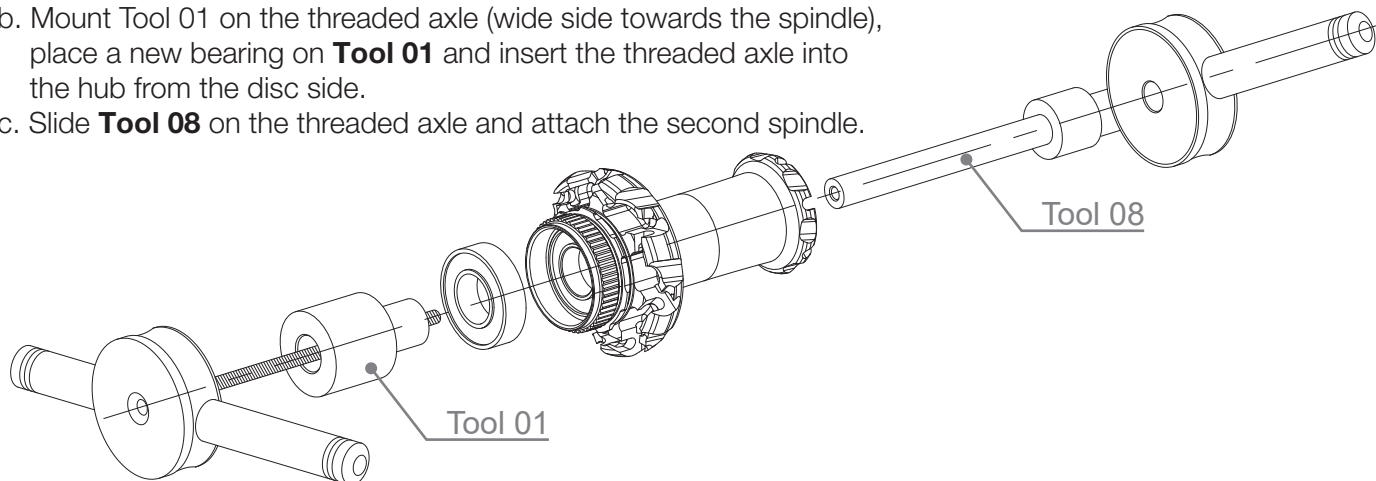

STEP 2

Tighten the spindles until the bearing is fully pressed into the hub shell.

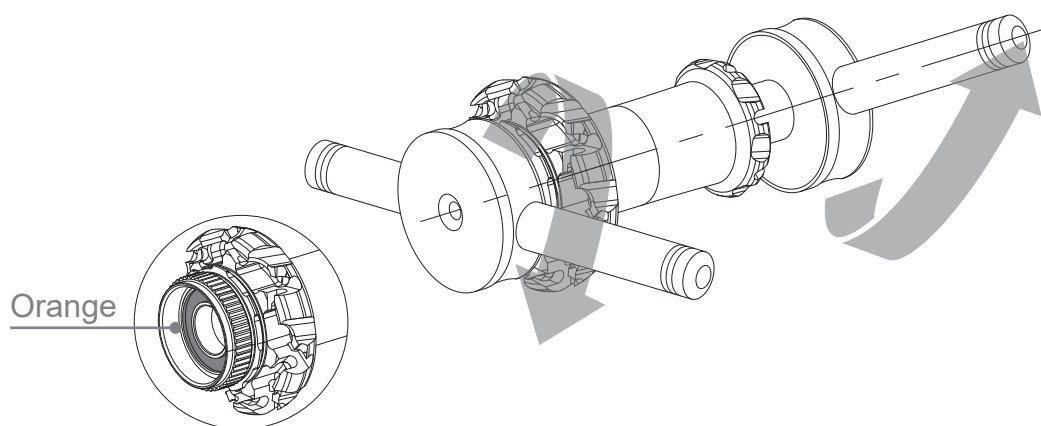

STEP 3

Assemble bearing of Non-disc side.

- Attach the threaded axle to one of the spindles.
- Mount **Tool 01** on the threaded axle (wide side towards the spindle).
- Slide the threaded axle through the hub shell.
- Place the hub axle on the threaded axle.
- Loosely mount a bearing on the hub shell.
- Insert **Tool 05** with the narrow side in the bearing (slide over threaded axle).
- Mount a second spindle.

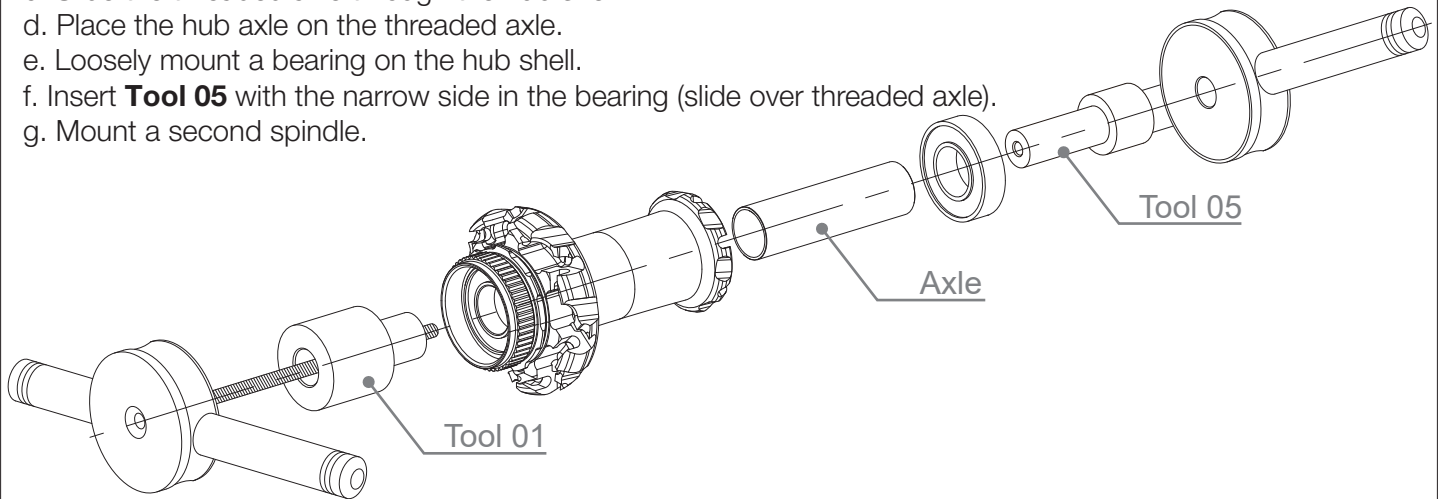

STEP 4

Tighten spindles until the bearing is fully pressed in the hub shell.

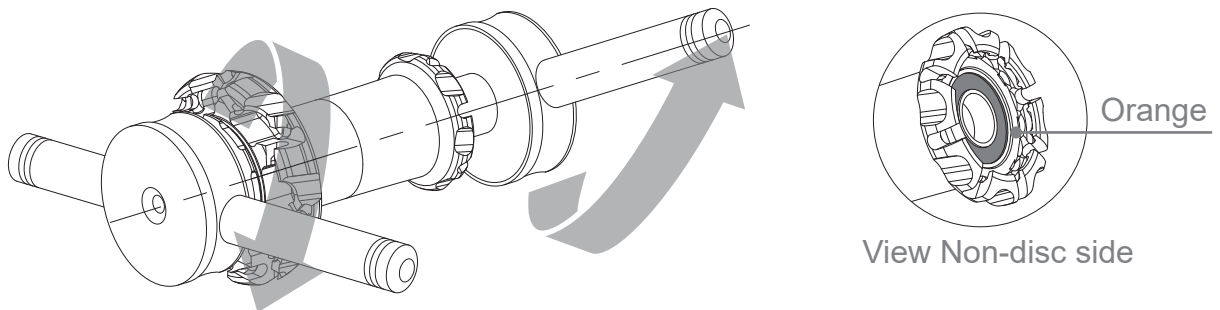

STEP 5

- After every bearing replacement, please glue the bearing in to the hub shell by using Loctite 290 and dry for 24+ hours. Pay special attention not to let excess Loctite dry on the waterproof cover.

Clean off excess glue immediately. Glue both sides of front hub.

- Place the end caps back on the hub.

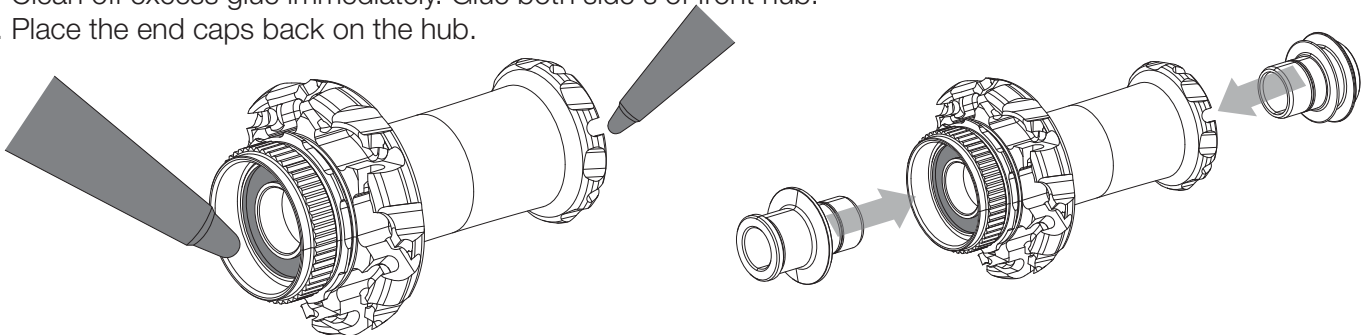

5 Rear Rim/Disc Brake Hub

5-1 Hub Disassembly

STEP 1

- Take off the end caps.
- Pull off the freehub body from the hub.
- Use tweezers to take out the star ratchet from the hub.

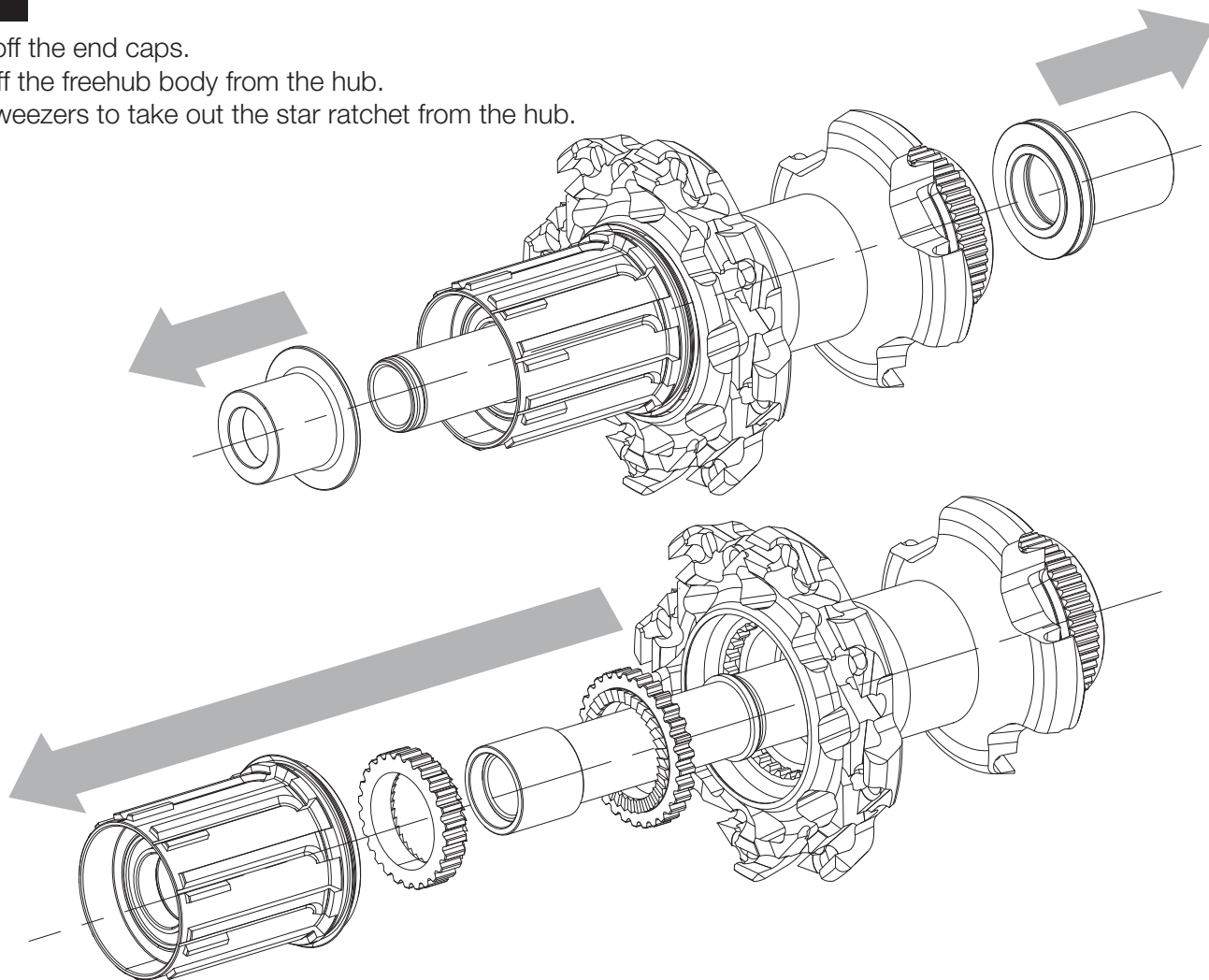

STEP 2

Remove bearing of Non-disc side.

- Attach the threaded axle to one of the spindles.
 - Mount **Tool 07** onto the threaded axle.
 - Insert the threaded axle into the hub axle from non drive side (wide side of **Tool 07** towards the hub).
- Attach the second spindle to the threaded axle.

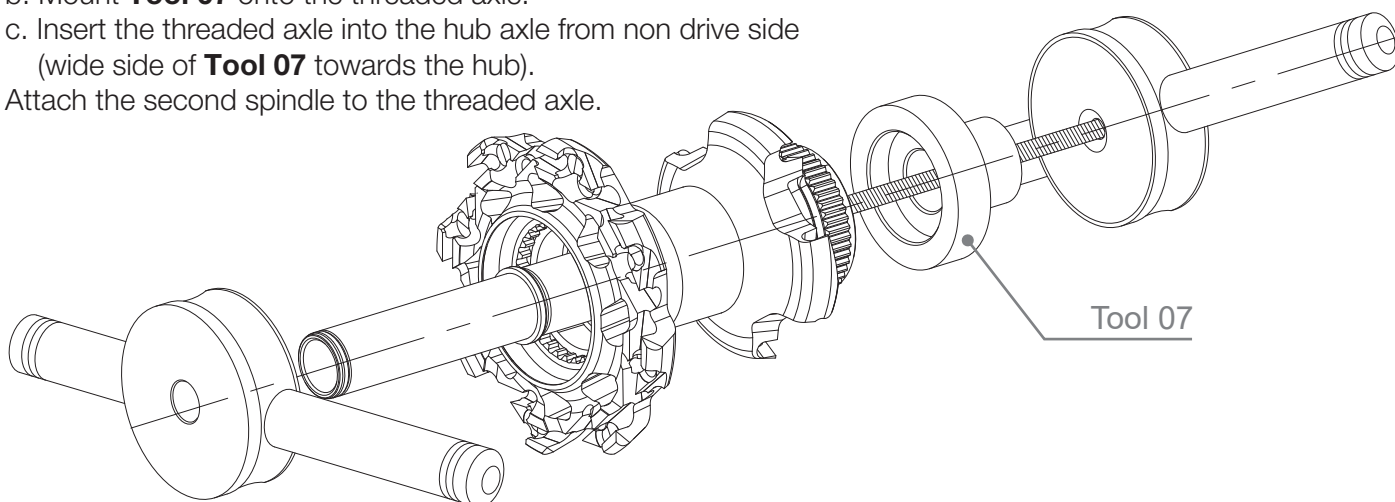

STEP 3

- Tighten the spindles, the bearing at **Tool 07** side (non drive) will be pushed out of the hub shell.
- Loosen the spindles to take out the threaded axle take off the disassembled bearing.

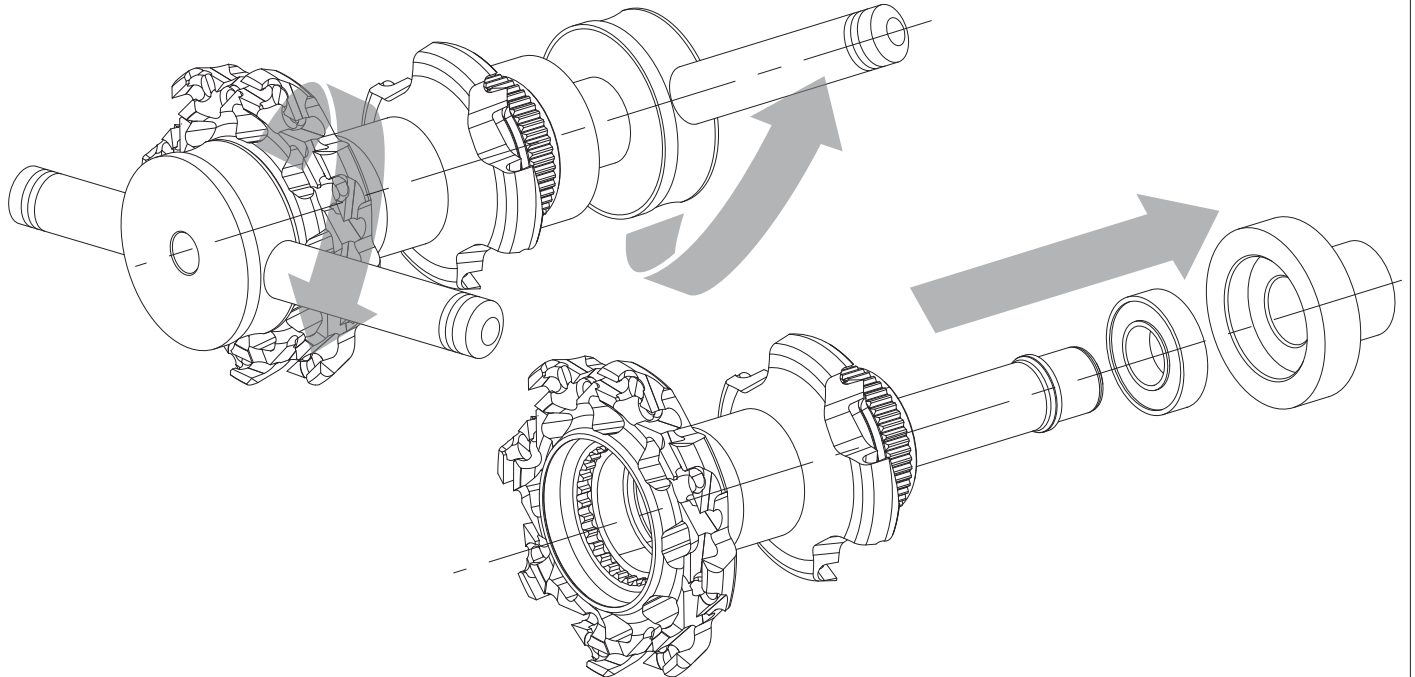

STEP 4

Remove bearing of Disc side.

Take out the hub axle and place it back with the long side towards non drive side.

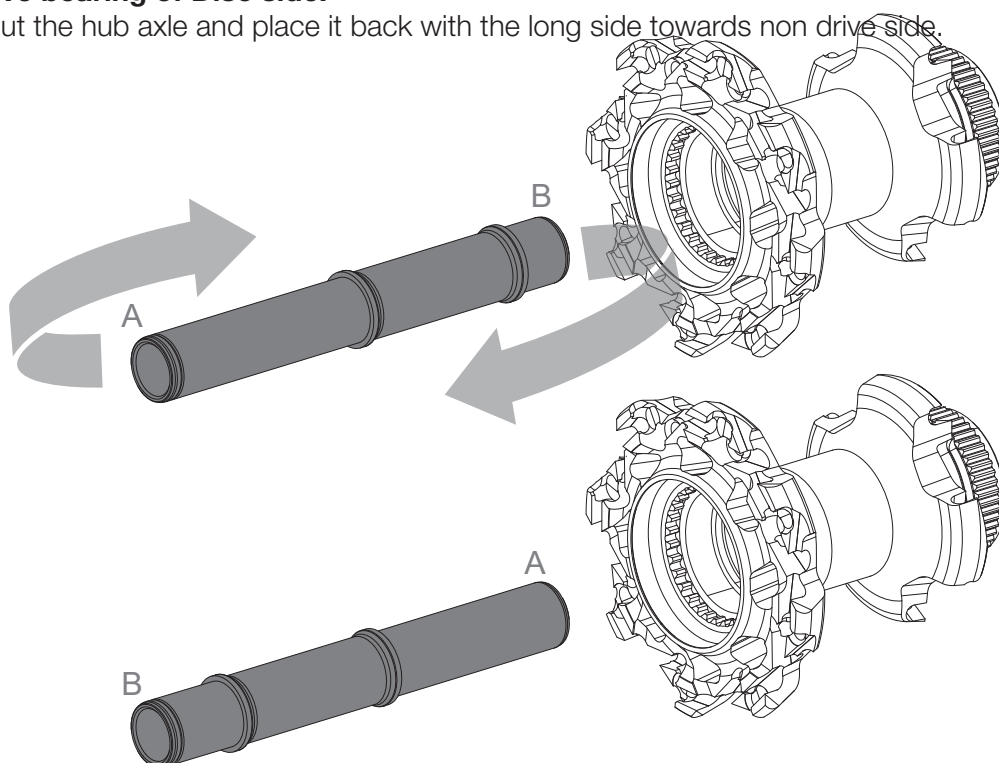

STEP 5

- Attach the threaded axle to one of the spindles.
- Insert the threaded axle into the hub axle from non-drive side.
- Slide **Tool 07** on the threaded axle (wide side towards hub shell).
- Attach the second spindle to the threaded axle.

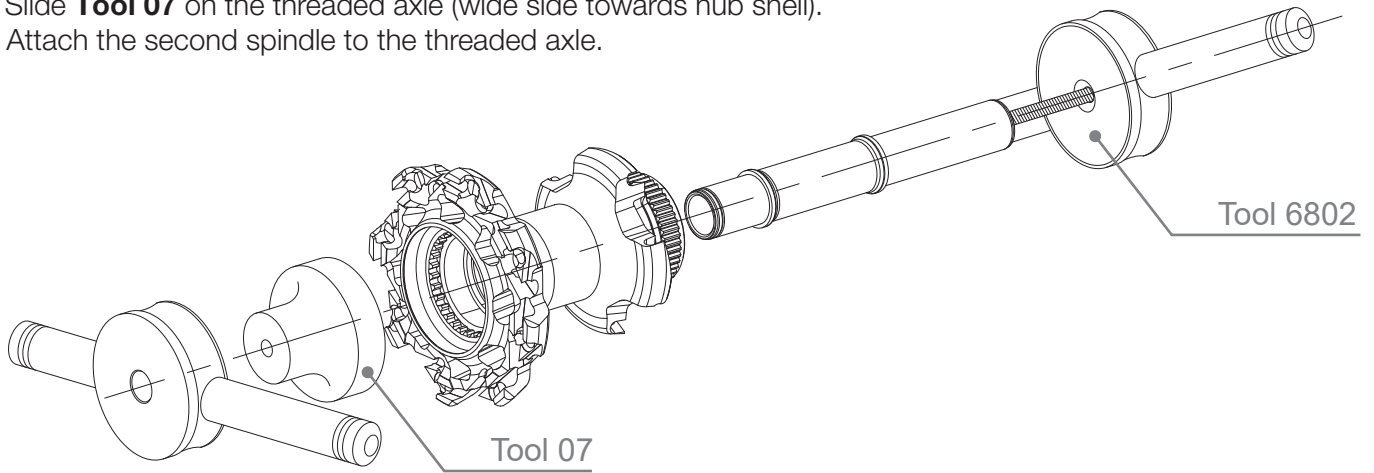

STEP 5

Tighten the spindles until the bearing at drive side is pushed out of the hub shell

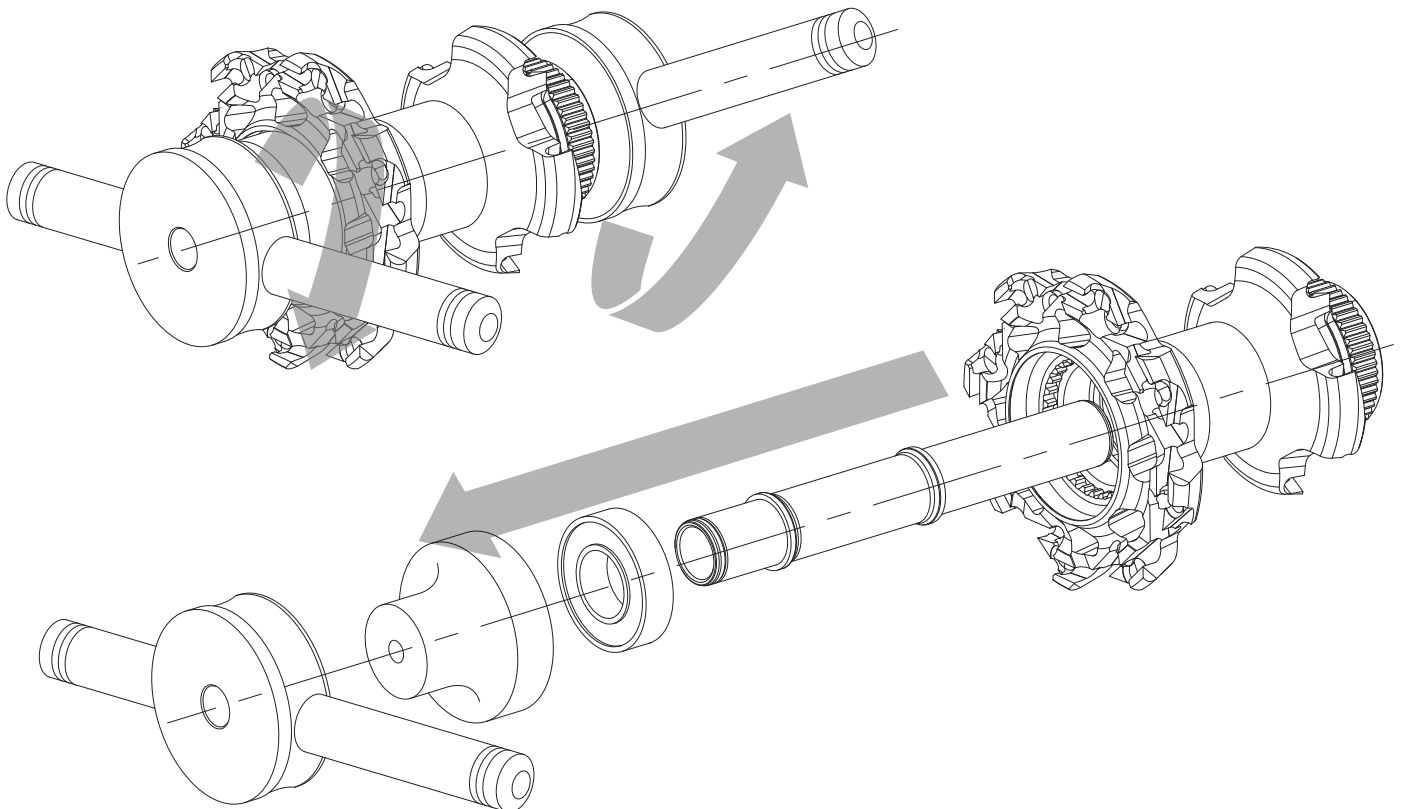

5-2 / Hub Disassembly

STEP 1

Assemble bearing of Drive side.

- Attach the threaded axle to one of the spindles.
- Slide **Tool 04** and **Tool 01** on the threaded axle, mount a bearing on the narrow side of **Tool 01**
- Insert the threaded axle in the hub shell from drive side.
- Slide **Tool 08** over the threaded axle and into **Tool 01** in the hub shell
- Attach the second spindle to the threaded axle.

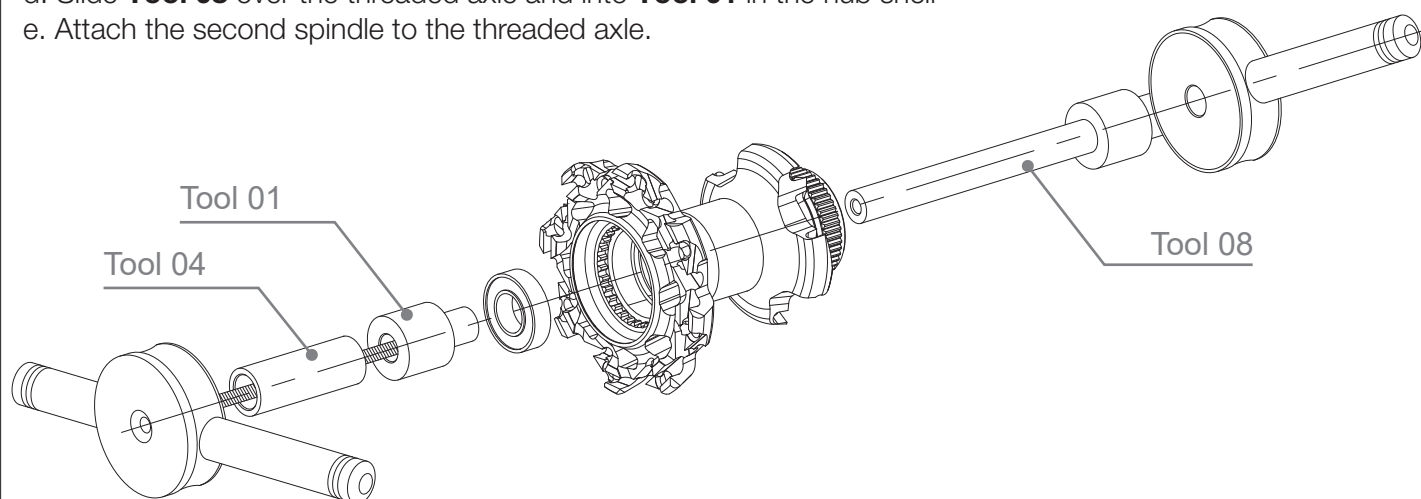

STEP 2

Tighten spindles until the bearing is fully pressed in the hub shell.

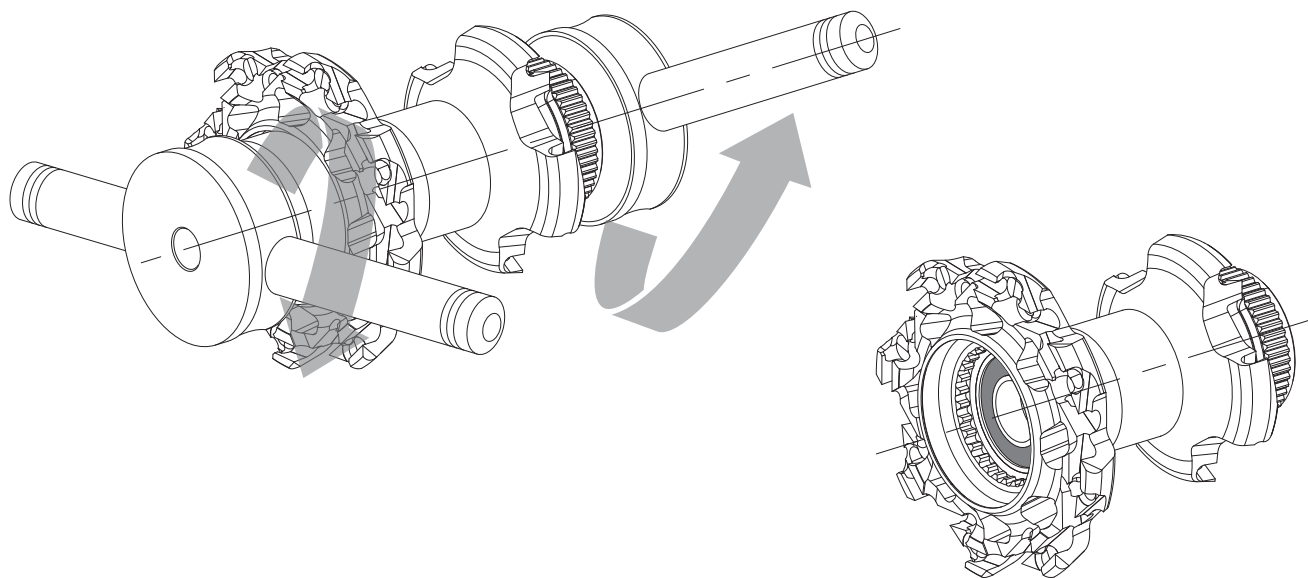

STEP 3

Assemble bearing of Non-drive side.

- Attach the threaded axle to one of the spindles.
- Slide **Tool 6802**, bearing and the hub axle on the threaded axle.
- Insert the threaded axle into the hub shell, through the bearing on drive side.
- Slide **Tool 03** & **Tool 04** onto the threaded axle.
- Attach the second spindle to the threaded axle.

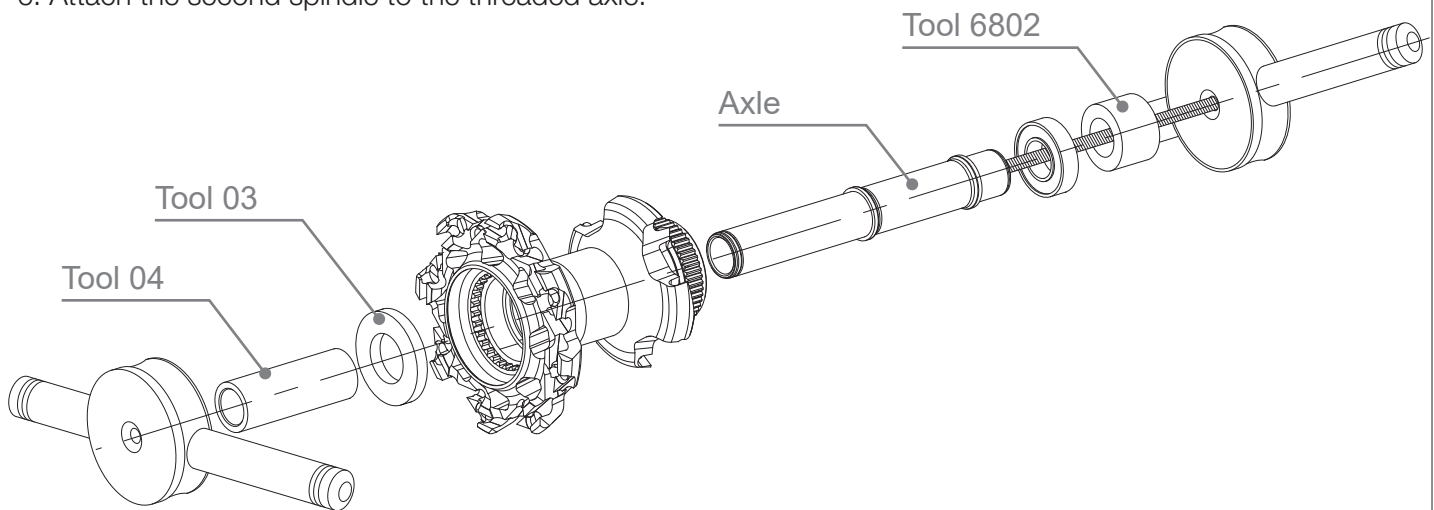

STEP 4

Tighten spindles until the bearing is fully pressed in the hub shell.

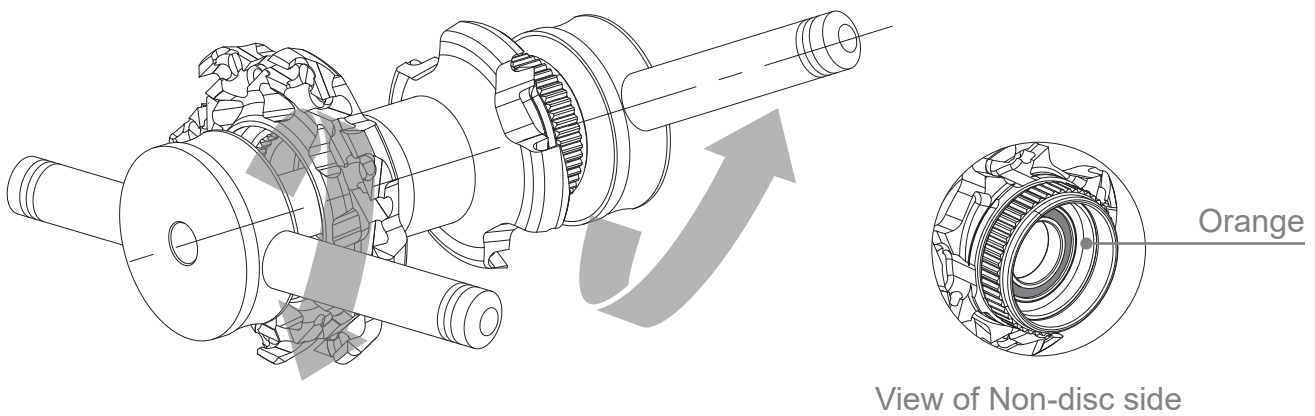

STEP 5

After every bearing replacement, please glue the bearing into the hub shell by using Loctite 290 and dry for 24+ hours. Pay special attention not to let excess Loctite dry on the waterproof cover. Clean off excess glue immediately.

Rear hub, non-drive side only.

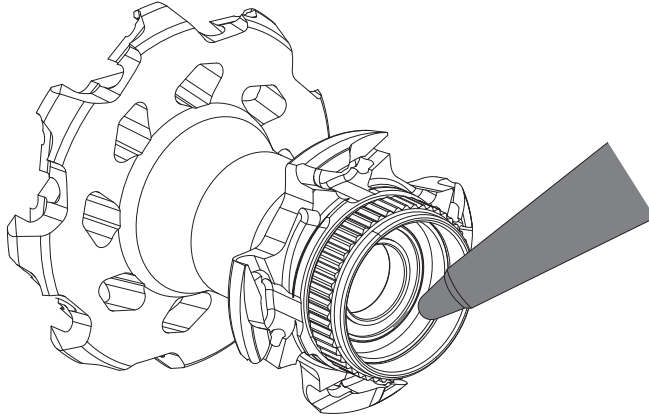

STEP 6

Freehub body star ratchet disassembly

- Take off the internal spacer.
- Remove the star ratchet from the freehub body.
- Use tweezers to pull out the spring from the freehub body.
- Apply a thin layer of grease on both sides of the bigger star ratchet.
- Place the star ratchet back into the hub shell. The flat (non serrated) side should be on the inside, serrated side facing outward.
- Place the spring, **with the wide side facing inwards**, back into the freehub body.
- Apply a thin layer of grease on both sides of the smaller star ratchet.
- Place the star ratchet back into the freehub body **with the serrated side facing outward (flat side against the spring)**.
- Place the spacer back into the freehub body.
- Mount the freehub body back onto the rear hub.

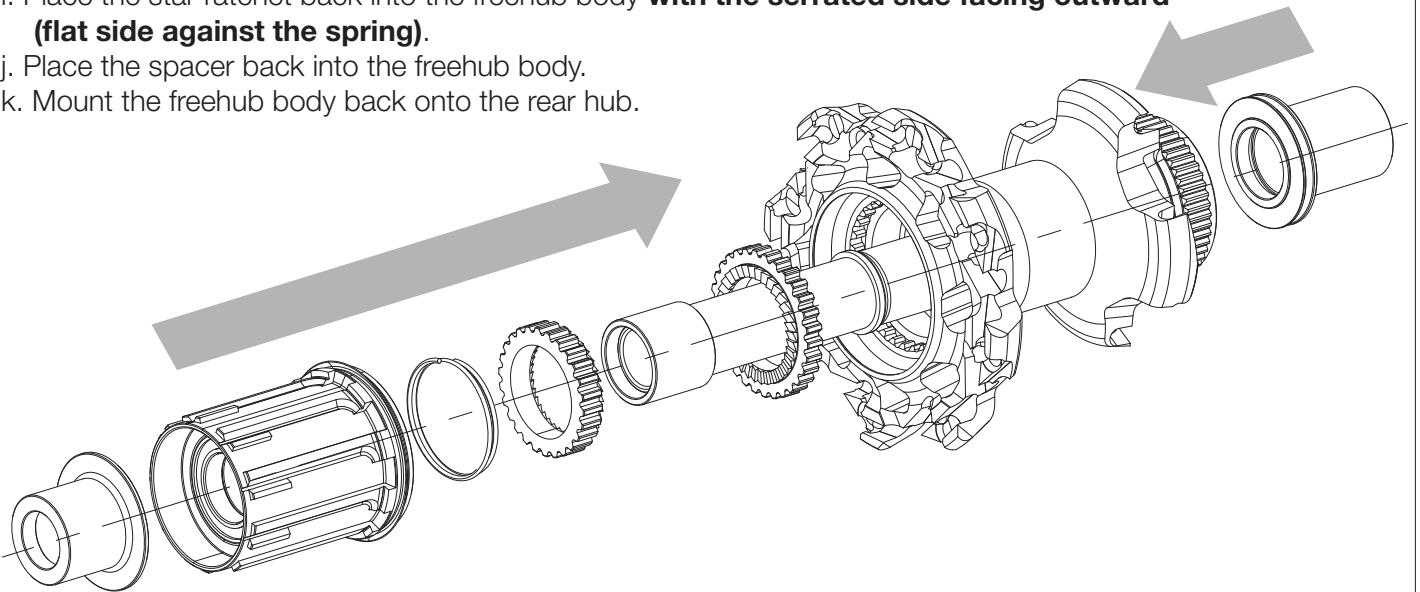

www.cadex-cycling.com/global/manuals

