

| ENGLISH |

# GIANT G-2 CLIP-ON SYSTEM ADAPTER KIT

USER MANUAL

***GIANT***

The G-2 Adapter Kit allows virtually any rack with no side rails to carry a compatible bag featuring the G-2 Clip On System.

## CONTENT

Tools Required: 4 mm Allen key, ruler or measuring tape

Compatibility: Fits rack tube diameter  $\varnothing 9\text{mm}$  -  $\varnothing 14\text{mm}$

- 1 G-2 Adapter Frame with connector studs
- 2 Clips (with nuts) x 2
- 3 M4 bolts x 2
- 4 Clip fasteners x 2
- 5 1.5 mm shims x 2
- 6 1.0 mm shims x 2

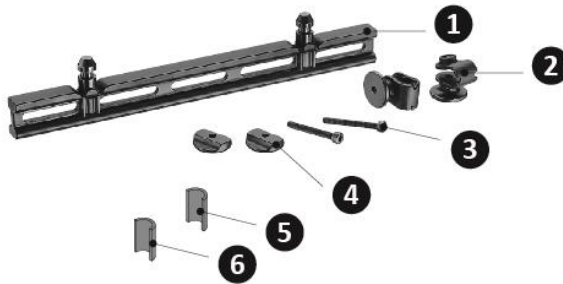

## INSTALLATION

1. (Fig A) Attach the two clips (A-1) to the same side of rack legs (A-3). To ensure a snug fit, you may have to use sizing shims (A-2).

Rack Leg Diameter	Sizing Shim
9-10mm	1.5mm
10-12mm	1.0mm
12-14mm	None

2. (Fig B) Attach the G-2 Adapter Frame to the clips with logo side facing outward and connector studs facing upwards.  
Secure G-2 Adapter Frame and clips with clip fasteners (B-1), flat side facing outward, and M4 bolts (B-2) and 4mm Allen key (Torque: 1.5Nm).

3. (Fig C) Adjust the mounting position of clips to make sure the frame is level.

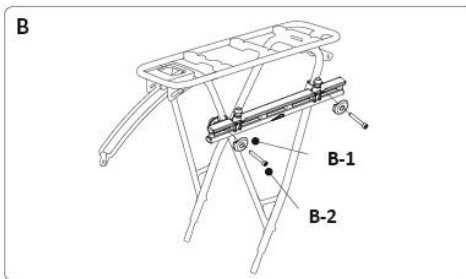
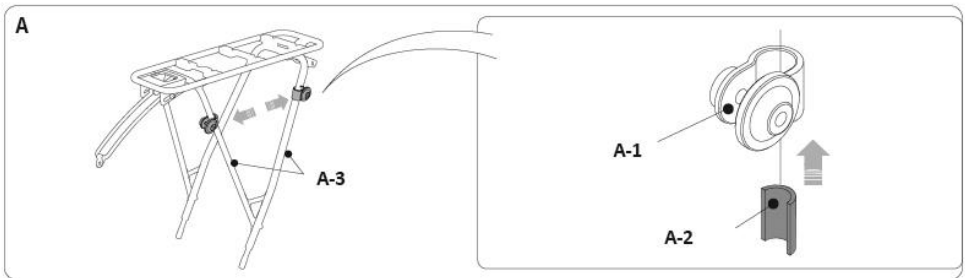

## PANNIER BAG ATTACHMENT AND DETACHMENT

### ATTACHMENT (FIG D)

Align stud recesses (D-1) of bracket latch with studs(D-2) of side rail(D-3) and gently push the pannier to let the bracket latch engage until you hear a click.

Fasten the rear rack fixing strap and buckle if needed (D-4)

### DETACHMENT (FIG E)

Press the two levers (E-1) on the bracket latch and lift the pannier up with the handle strap at the same time.

### NOTE

If you find it difficult to attach/release pannier, please adjust the G-2 side pole adapter.

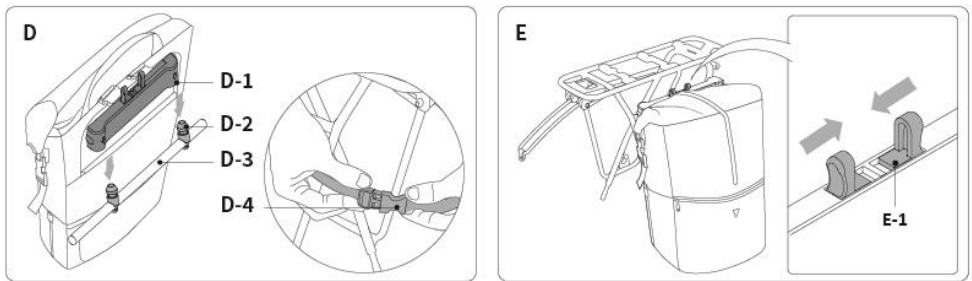

### ⚠WARNING

- Not compatible with seatpost-mounted carriers and some types of city bike carriers.
- If your heel brushes pannier when pedaling, reposition the side frame of the G-2 kit.
- Always ensure pannier is secure on the rack and no straps or other items are protruding before riding.
- Pannier to rack fully loaded, and shake bike and rack left and right. If any part of pannier touches the wheel, consult a bicycle shop for advice.
- Do not use for off-road riding.
- For better stability, pack the heaviest items at the bottom of pannier. It is better to use a pair of pannier bags with evenly distributed weight on both sides for better balance and control.