

## ! WARNING/CAUTION

- This light emits an extremely powerful beam equivalent to auto-mo-bile headlight so it may cause a hazardous situation depending on the beam angle used.
- Be sure to direct the light beam downward so the driver approaching does not get dazzled.
- Do not use high mode on public roads.
- Before your trip, please make sure the light is firmly mounted to the bracket, it lights up, and the light is not blocked by baggage, etc.
- Do not stare at the light when it is illuminating. Otherwise it may damage your eyesight.
- Do not place it within children's reach.
- In preparation for unexpected battery shutoff, we recommend you carry a spare light.
- This product is water-resistant under normal daily use and can be used in the rain. However, do not intentionally submerge it in water.
- If the light unit or parts become dirty with mud, etc., clean with a soft cloth which is moistened with mild soap. Never apply paint thinner, benzene or alcohol; damage will result.
- This unit is shipped with a small charge to check the light. Be sure to charge it before use, according to the instructions "HOW TO CHARGE".
- The light source contained in this luminaire shall only be replaced by the manufacturer or his service agent or a similar qualified person.
- This appliance contains batteries that are only replaceable by skilled persons.
- The luminaire should be positioned so that prolonged staring into the luminaire at a distance closer than 2.5 m is not expected.
- Do not stare at the operating light source.
- When the product is abandoned or not in use, do not throw it away in the garbage can, it should be put in the waste battery treatment point.



## SWITCHING THE LIGHTING MODE



When you turn the light on, it light up in the last lighting mode you used. (Mode memory function)

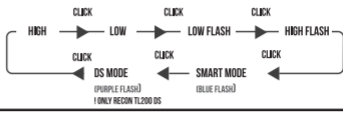

## LUMENS/RUNTIME

### RECON HL 200

ANSI	HIGH	LOW	HIGH FLASH	LOW FLASH	SMART(DAY)	SMART(NIGHT)
	200 LUMENS	50 LUMENS	150 LUMENS	10 LUMENS	100 LUMENS	30 LUMENS
	03:00 h:min	07:00 h:min	15:00 h:min	30:00 h:min	06:00 h:min	20:00 h:min

### RECON TL 200

ANSI	HIGH	LOW	HIGH FLASH	LOW FLASH	SMART(DAY)	SMART(NIGHT)
	100 LUMENS	50 LUMENS	200 LUMENS	10 LUMENS	200 LUMENS	30 LUMENS
	02:30 h:min	05:00 h:min	06:00 h:min	25:00 h:min	06:00 h:min	10:00 h:min

## BATTERY INDICATOR

- GREEN STEADY: 100%-70%
- ORANGE STEADY: 70%-40 %
- RED STEADY: 40%-20%
- RED FLASH: 20% <



## HOW TO CHARGING

Always charge the product before use.

Standard charging time  
Approx. 2-4 hrs



GREEN FLASHES

Charging



GREEN ILLUMINATES

Fully Charging



## HOW TO INSTALL

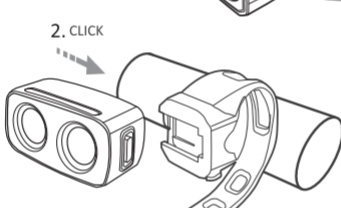
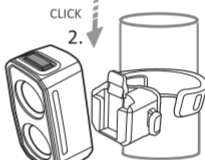
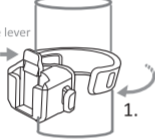

## HOW TO MOUNT

The mounting buckle and/or thumb screw, depending on the mount you are using.

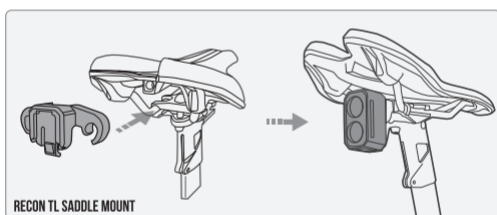

RECON TL SADDLE MOUNT

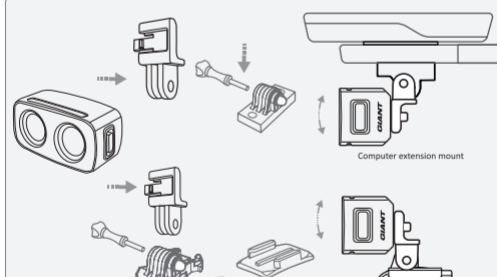

RECON HL200 GOPRO MOUNT

## SPARE/OPTIONAL PARTS



RUBBER STRAP HL MOUNT  
SKU:400000180



RUBBER STRAP TL MOUNT  
SKU:400000181



GOPRO MOUNT  
SKU:400000177



SADDLE RAIL MOUNT  
SKU:400000178



HELMET MOUNT  
SKU:400000179