

INTERNAL CABLE GUIDE POSITIONING INSTRUCTIONS

Apply the supplied tape on the steerer tube to secure the internal stopper on the correct position.

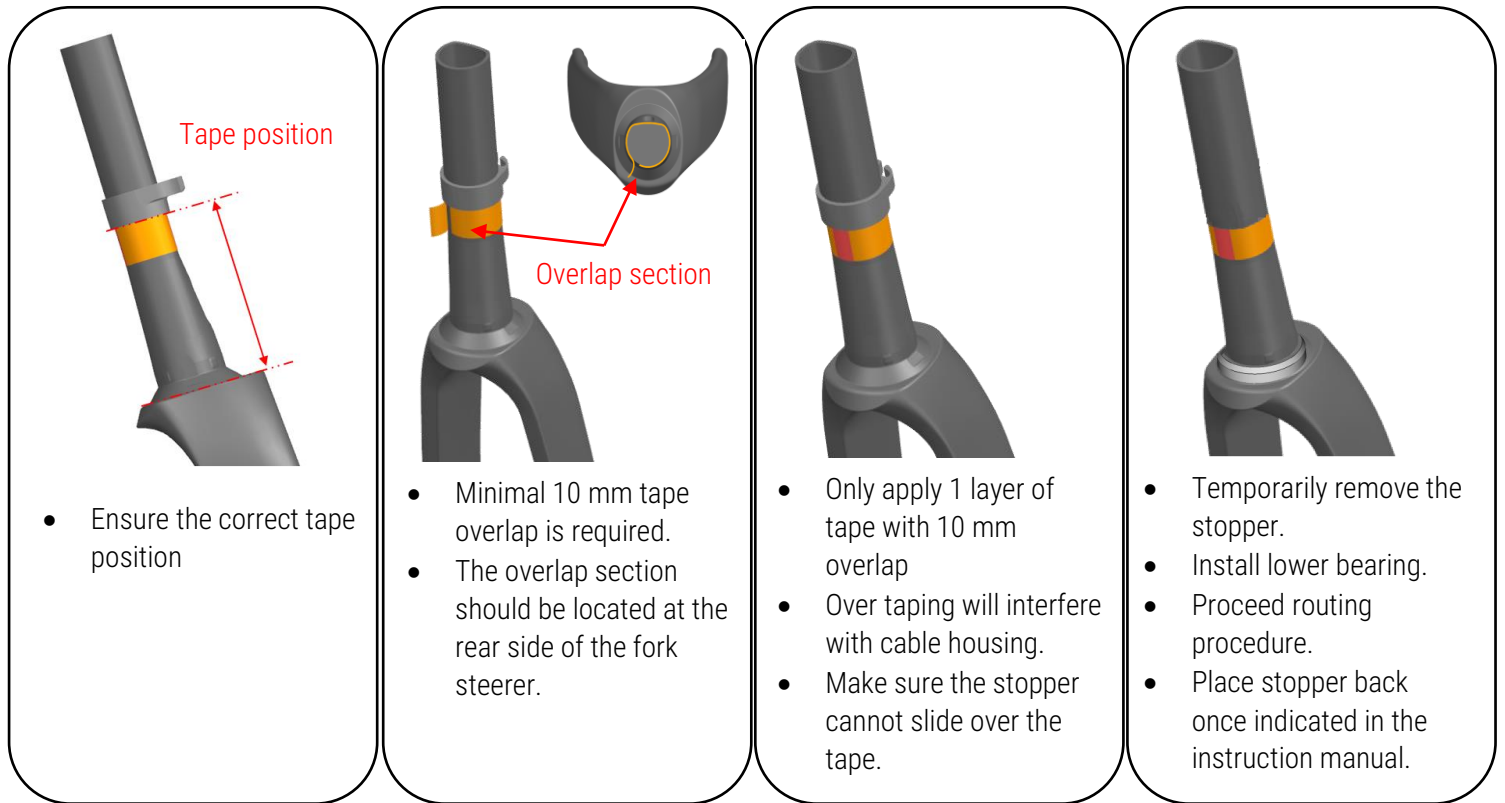

Notes:

1. Tape must be applied on the position as described in the table on the next page.
2. Tape position is measured from the bearing surface on the fork to the upper edge of the tape. (Tape sku: **226T-T2001-032**)
3. The stopper is directional and must be placed with the cable hooks on the upside.

CAUTION: INCORRECT POSITIONING OF THE INTERNAL STOPPER MAY CAUSE STEERING ISSUES OR DAMAGES TO THE FRAME.

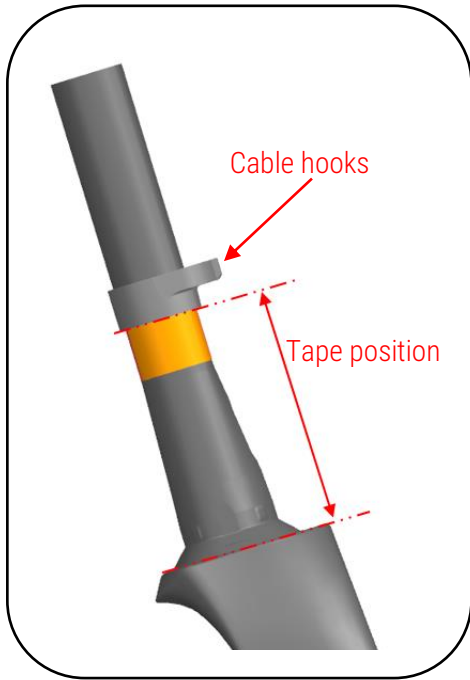

Size	Head Tube Length (w/o Cone spacer)	Tape location (ADV SL)	Tape location (ADV)
Propel Frame		Propel Fork	
XL	190	160	160
L	175	145	145
ML	155	125	125
M	135	105	105
S	120	90	90
XS	110	80	80
EnviLiv Frame		EnviLiv Fork	
L	165	135	135
M	145	115	115
S	125	95	95
XS	110	80	80
XXS	95	70	70

(mm)

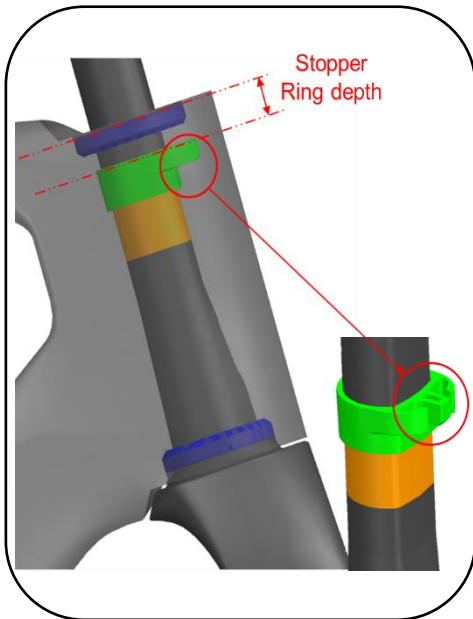

Size	Head Tube Length (w/o Cone spacer)	Stopper Ring depth (ADV SL)	Stopper Ring depth (ADV)
Propel			
XL	190	15	15
L	175		
ML	155		
M	135		
S	120		
XS	110		
EnviLiv			
L	165	15	15
M	145		
S	125		
XS	110		
XXS	95	10	10

(mm)

For more information, please visit: <https://www.giant-bicycles.com/global/manuals>

If you encounter difficulties or are uncertain about anything mentioned in this user manual, please contact a Giant authorized retailer.

