

# INSTRUCTION MANUAL

**GIANT**

## Integrated Seat Post(ISP) Protector for ThinLine Paint Application

### 1 **! WARNING**

After cutting the ISP to the correct length, the clamp must at least cover the indicated area as shown below. The end of the ISP must not be below the minimum insertion mark on the ISP clamp.

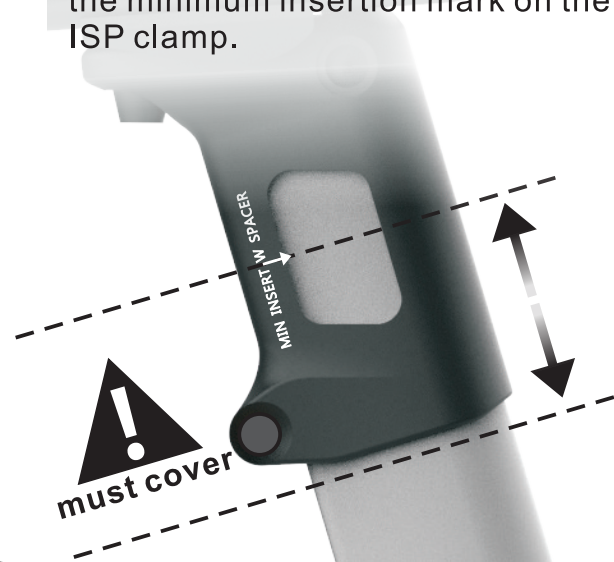

### 2 Clean the surface thoroughly.

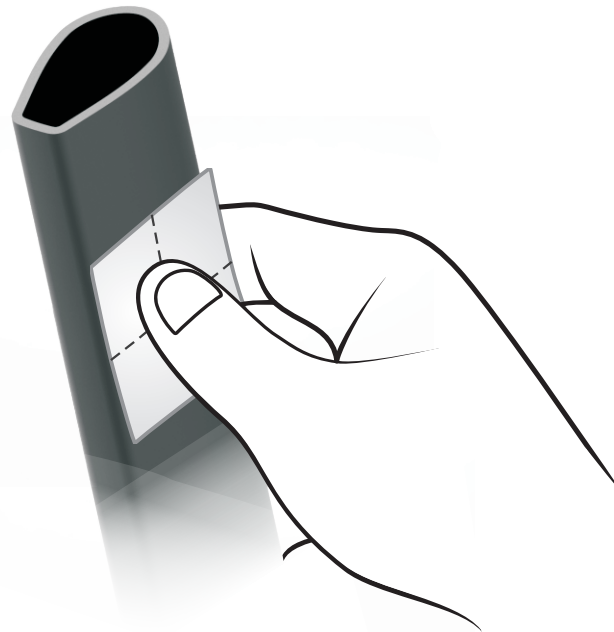

### 3 Wet the ISP protector with clean water and apply it to the ISP. (Easy to position correctly when wet.) Make sure to apply the protector from side to side as indicated below.

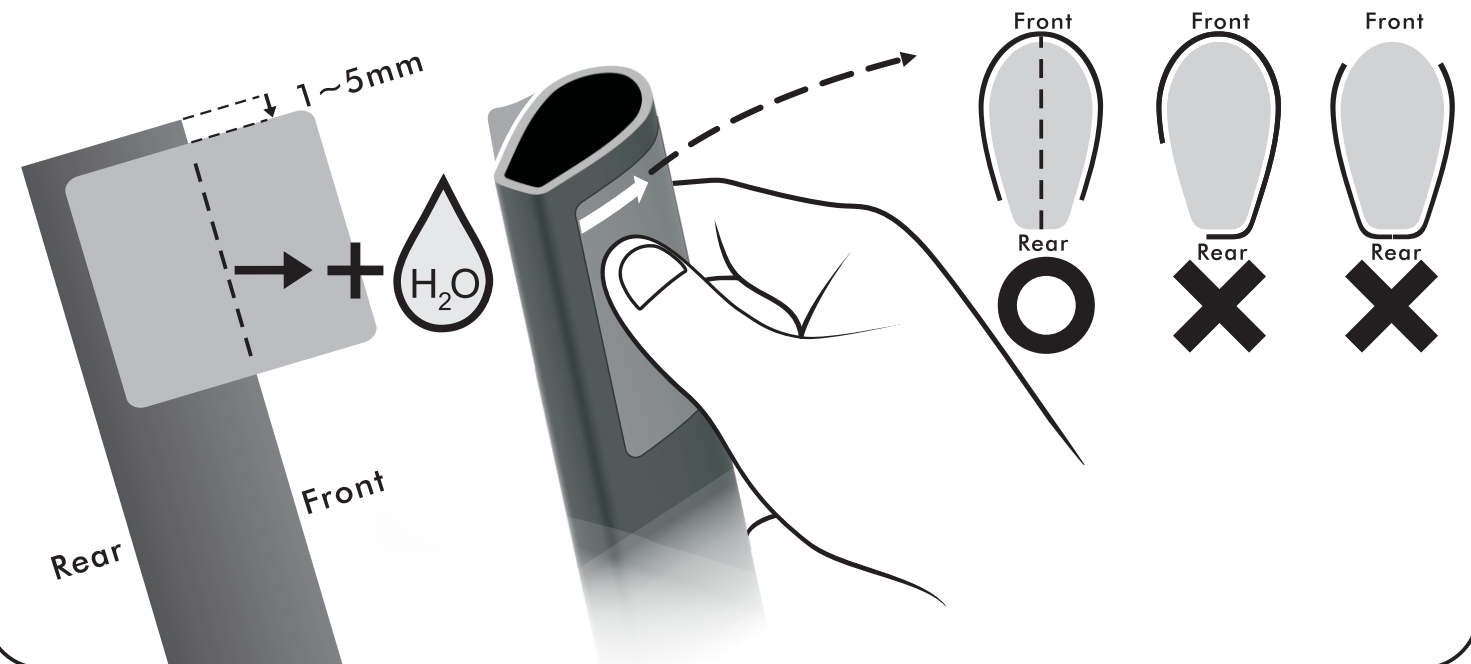

### 4 Use a clean and dry cloth to remove water residue and push out any air bubbles from under the protector with your fingertips.



### 5 Let the ISP protector and ISP surface dry completely before proceeding to step 6.



### 6 Install the ISP clamp and saddle and tighten to indicated tightening torque.



### CAUTION

When saddle height is adjusted, the described steps need to be repeated.



If you encounter difficulties or are uncertain about anything mentioned in this user manual, please contact a Giant authorized retailer.

For more information, please visit:  
<https://www.giant-bicycles.com/global/manuals>

To find a Giant authorized retailer or to learn more about Giant Bicycles, please visit: [www.giant-bicycles.com/global](https://www.giant-bicycles.com/global)